

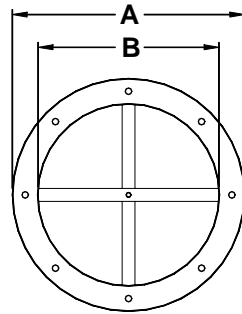

1212 FGR-IL

Inline Spiral Silencer



FACE

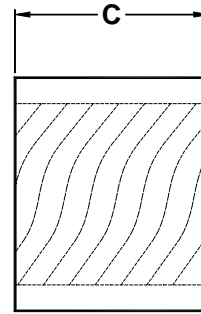

SIDE

Dimensions				
A = Dia. O.D.	B = Dia. I.D.	C = Length	Face Flow I.D.	Net Weight
16 in.	12 in.	13 in.	12 in.	20 lbs.

DYNAMIC INSERTION LOSS

Octave Bands	1	2	3	4	5	6	7	8
Center Freq. Hz	63	125	250	500	1000	2000	4000	8000
Face Velocity	Dynamic Insertion Loss in Decibels							
-4000	18	20	19	28	29	30	32	37
-3000	18	20	19	28	29	30	32	37
-2000	17	20	19	28	29	29	31	36
-1000	17	20	18	27	29	29	31	36
+1000	17	19	18	27	28	29	31	37
+2000	17	19	18	27	27	29	31	37
+3000	16	19	18	27	27	28	31	36
+4000	16	19	18	26	27	29	31	37

AERODYNAMIC PERFORMANCE DATA

Static Pressure Loss in Inches of H ₂ O										
	.05	.10	.15	.20	.25	.30	.40	.50	.75	1.00
Airflow in CFM	240	625	775	895	1005	1100	1260	1420	1735	2010

Tel: (909) 796-6200



Fax: (909) 796-6223



1212 FGR-IL

SELF GENERATED SOUND RATINGS

Forward Flow								
Octave Bands	1	2	3	4	5	6	7	8
Center Freq. Hz	63	125	250	500	1000	2000	4000	8000
Face Velocity	Generated Sound in Sound Power Level (Lw) (dB re 10 ⁻¹² Watts)							
1000	(52)	(41)	(31)	(22)	(18)	(19)	(22)	(25)
2000	(53)	(42)	(41)	40	40	41	(25)	(27)
3000	54	44	43	42	42	43	33	35

Reverse Flow								
Octave Bands	1	2	3	4	5	6	7	8
Center Freq. Hz	63	125	250	500	1000	2000	4000	8000
Face Velocity	Generated Sound in Sound Power Level (Lw) (dB re 10 ⁻¹² Watts)							
1000	(52)	(41)	(31)	(22)	(18)	(19)	(22)	(25)
2000	(53)	(42)	(41)	39	40	40	(25)	(27)
3000	53	44	42	42	42	43	33	35

NOTE: Sound power levels in parentheses have reached ambient levels in the test facilities test room or are determined by instrument limitations. Actual levels are less than or equal to levels indicated.

The above insertion loss values and self generated sound levels are extrapolated from actual test data from an independent testing facility per ASTM E477 "Standard Methods of Testing Duct Liner Materials and Prefabricated Silencers for Acoustical and Airflow Performance". Test reports available upon request.