

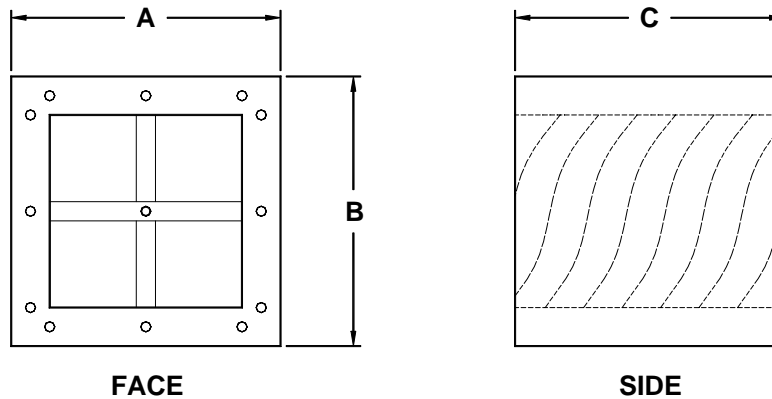

VA 99-1S-IL

## Inline Spiral Silencer



Dimensions				
A = Width	B = Height	C = Length	Face Flow I.D.	Net Weight
13 in.	13 in.	13 in.	9 in. X 9 in.	22 lbs.

### DYNAMIC INSERTION LOSS

Octave Bands	1	2	3	4	5	6	7	8
Center Freq. Hz	63	125	250	500	1000	2000	4000	8000
Face Velocity	Dynamic Insertion Loss in Decibels							
-4000	18	22	22	38	35	40	55	57
-3000	18	22	22	37	34	39	55	56
-2000	17	22	22	37	34	39	54	56
-1000	17	21	21	37	34	39	53	56
+1000	17	21	21	36	34	39	53	55
+2000	17	21	21	36	34	38	53	55
+3000	17	21	21	36	33	38	53	55
+4000	16	20	21	36	33	38	53	55

### AERODYNAMIC PERFORMANCE DATA

Static Pressure Loss in Inches of H <sub>2</sub> O										
	.05	.10	.15	.20	.25	.30	.40	.50	.75	1.00
Airflow in CFM	220	390	625	755	785	1190	1265	1450	1655	1740

Tel: (909) 796-6200



Fax: (909) 796-6223



VA 99-1S-IL

**SELF GENERATED SOUND RATINGS**

Forward Flow								
Octave Bands	1	2	3	4	5	6	7	8
Center Freq. Hz	63	125	250	500	1000	2000	4000	8000
Face Velocity	Generated Sound in Sound Power Level (Lw) (dB re 10 <sup>-12</sup> Watts)							
1000	(53)	(40)	(30)	(22)	(18)	(19)	(24)	(28)
2000	(54)	(41)	41	42	42	41	(25)	(28)
3000	58	44	42	43	44	42	34	40

Reverse Flow								
Octave Bands	1	2	3	4	5	6	7	8
Center Freq. Hz	63	125	250	500	1000	2000	4000	8000
Face Velocity	Generated Sound in Sound Power Level (Lw) (dB re 10 <sup>-12</sup> Watts)							
1000	(53)	(40)	(30)	(22)	(18)	(19)	(24)	(28)
2000	(54)	(41)	41	42	42	41	(25)	(28)
3000	58	44	42	43	44	42	34	40

**NOTE:** Sound power levels in parentheses have reached ambient levels in the test facilities test room or are determined by instrument limitations. Actual levels are less than or equal to levels indicated.

The above insertion loss values and self generated sound levels are extrapolated from actual test data from an independent testing facility per ASTM E477 "Standard Methods of Testing Duct Liner Materials and Prefabricated Silencers for Acoustical and Airflow Performance". Test reports available upon request.